

LEAPFROG GEOTHERMAL



leapfrog®
FAST, DYNAMIC GEOLOGICAL MODELLING

SURFACE TYPES

Leapfrog Geothermal 3.9

LEAPFROG GEOTHERMAL 3.9 SURFACES

CORE CONTACT SURFACE TYPES

Deposit

Erosion

Intrusion

Vein

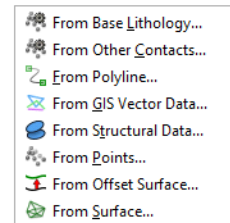
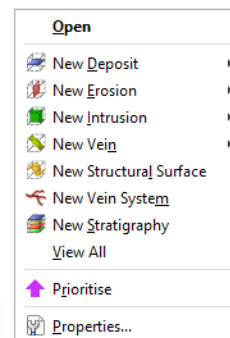

SPECIFIC FUNCTION SURFACES

Structural

Offset

Vein System

Stratigraphy

LEAPFROG GEOTHERMAL 3.9 SURFACES

CORE CONTACT SURFACE TYPES

Deposit

Shale - Gravel Contacts

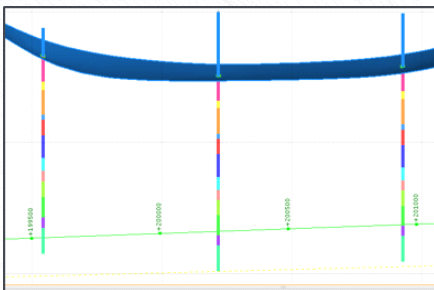

Erosion

Recent contacts

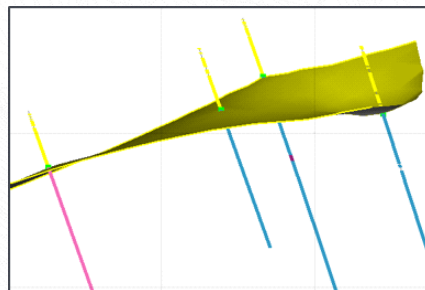

Intrusion

Early Diorite

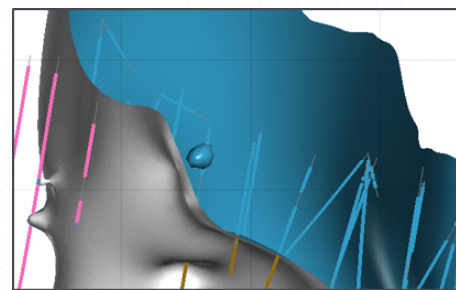

Vein

Dyke 1

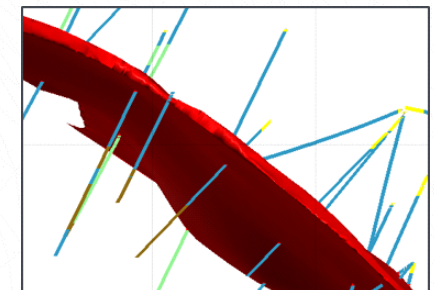

DEPOSIT AND EROSION SURFACE

One set of contact points – above OR below the unit of interest

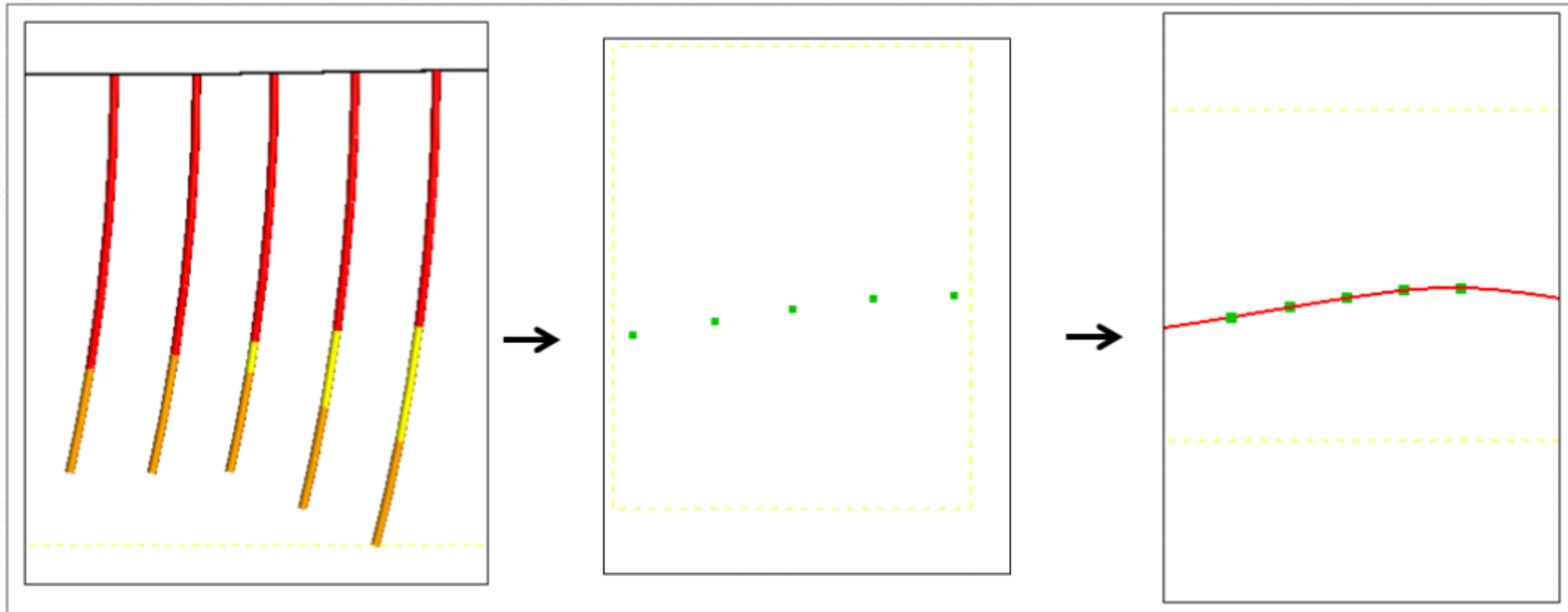

Only **ONE** contact point per unit per well

DEPOSIT AND EROSION VOLUMES

Deposit Surface

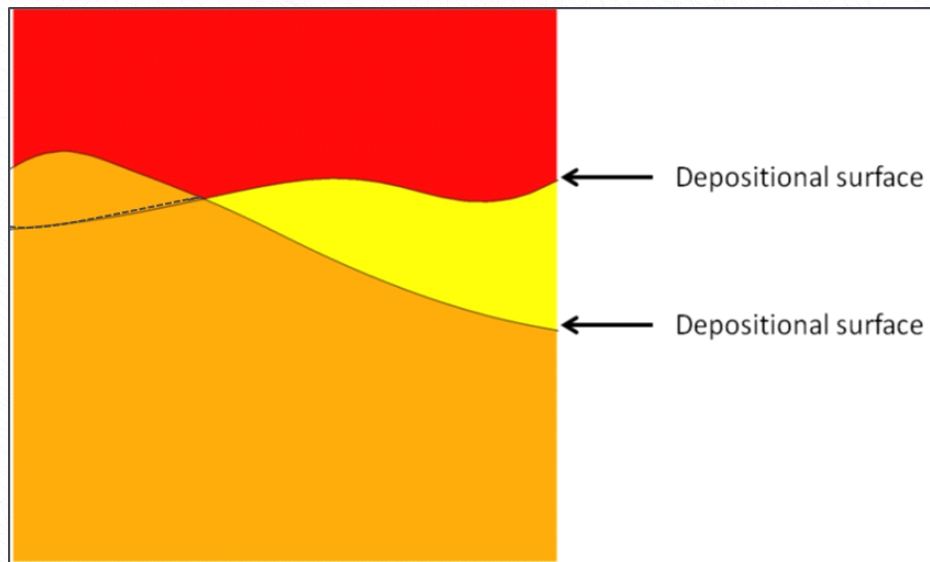

Cannot cut into an underlying older unit

Erosion Surface

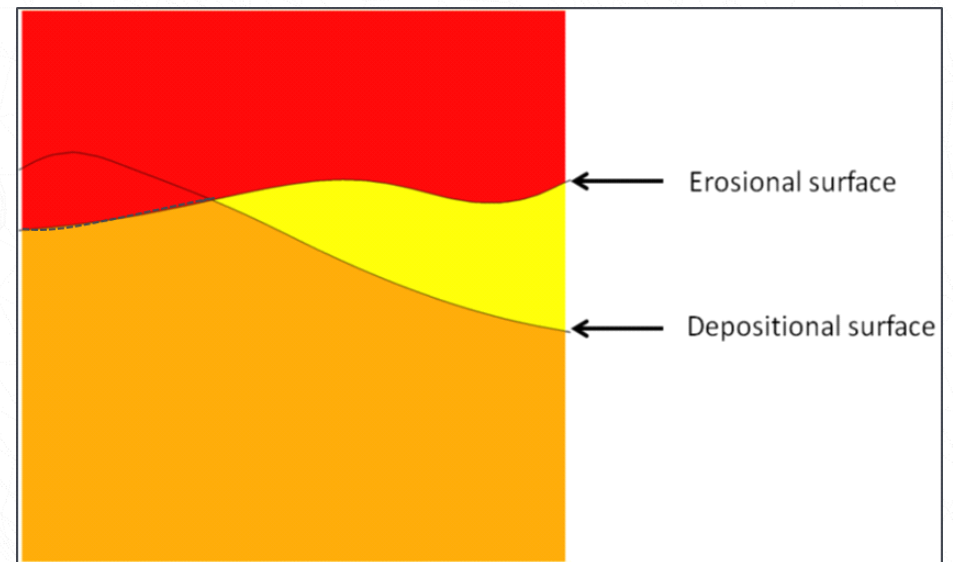

Can cut into an underlying older unit

INTRUSION SURFACE

One set of contact points – above **AND** below the unit of interest

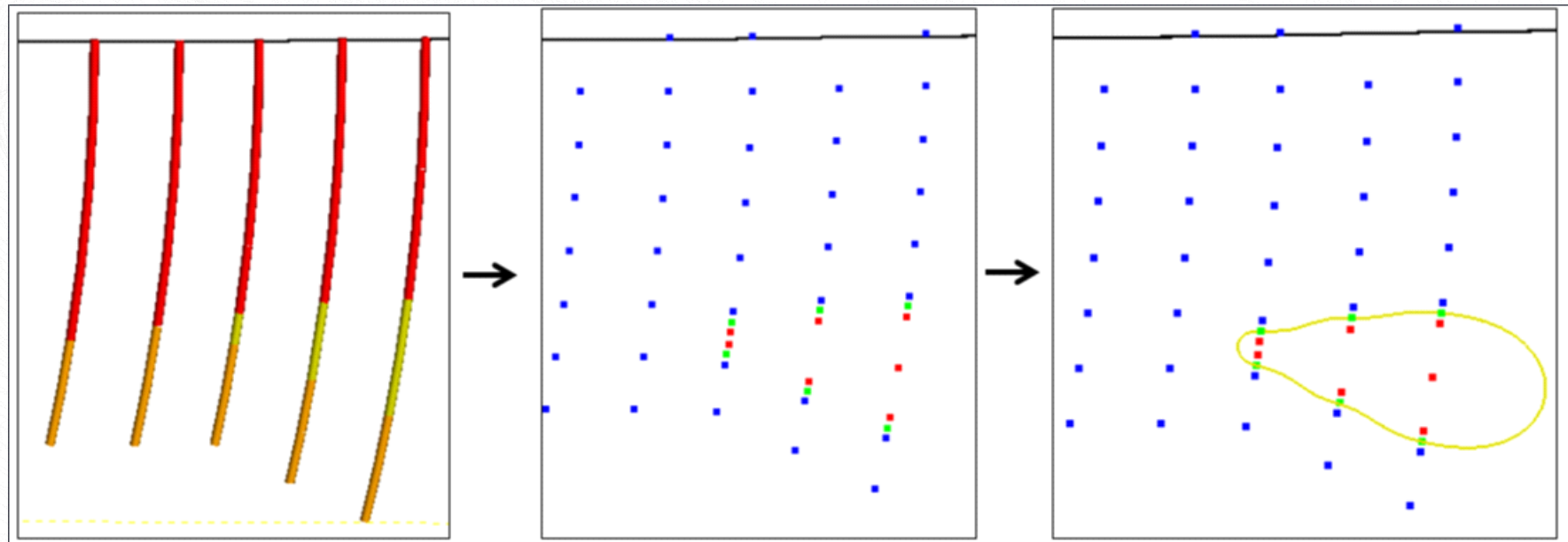

Can have **MULTIPLE** contact points per unit per well

INTRUSION VOLUMES

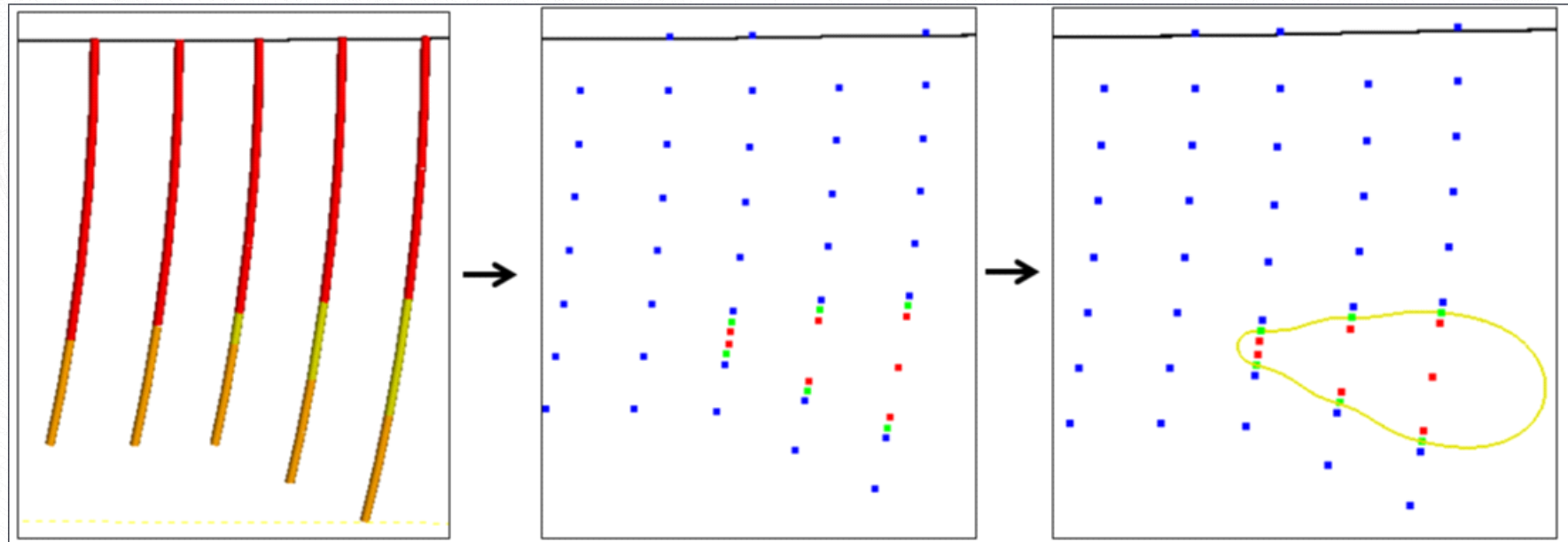

Encloses the unit of interest

VEIN SURFACE

Two sets of contact points – above **AND** below the unit of interest

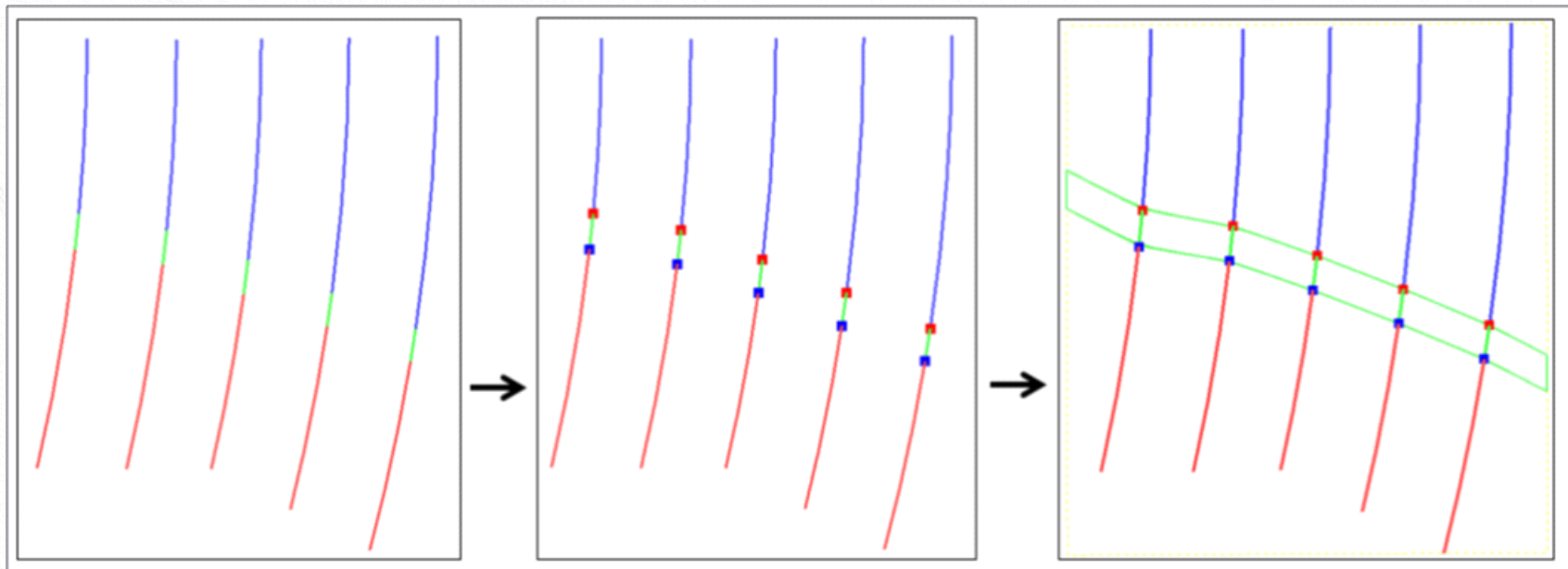

Creates a Hanging wall (HW) set **AND** Footwall (FW) set of contact points

SPECIFIC FUNCTION SURFACES

SPECIFIC FUNCTION SURFACES

Structural

Amuri - Enys Contacts

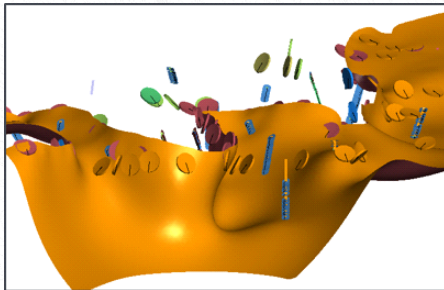

Offset

From Offset Surface...

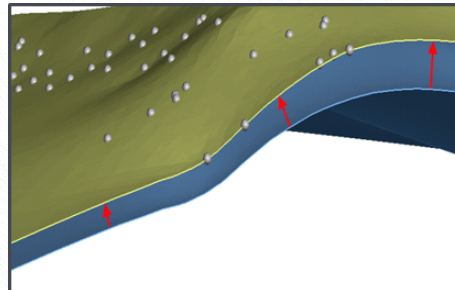

Vein System

Quartz Vein System

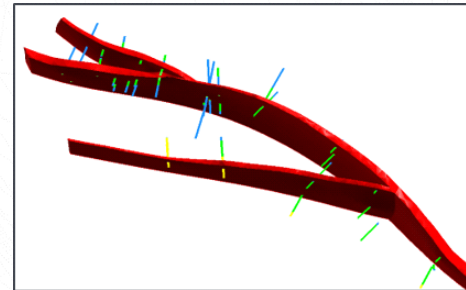

Stratigraphy

Stratigraphic Sequence

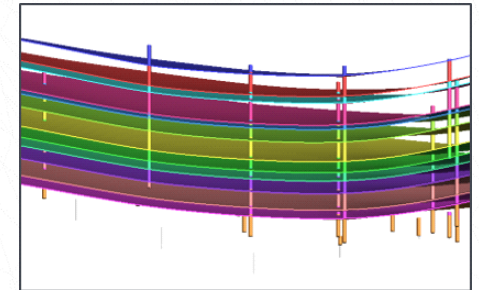

STRUCTURAL SURFACE

Incorporates **non-contact** structural data with on-contact data
(wells, surface mapping)

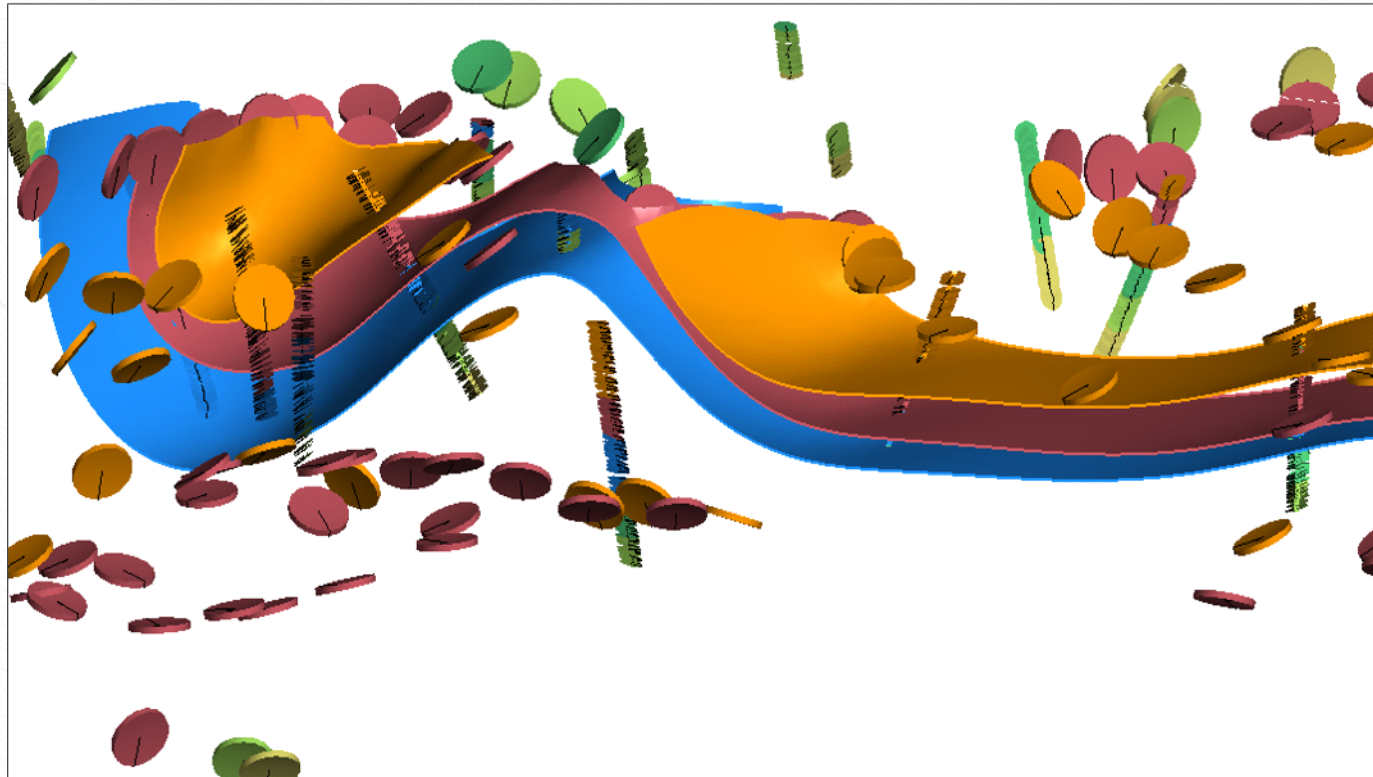

Can be used for a **Deposit**, **Erosion** or **Intrusion** contact type

OFFSET SURFACE

Maintains **consistent offset** while **honouring** contact points – for stratigraphy with common deformation

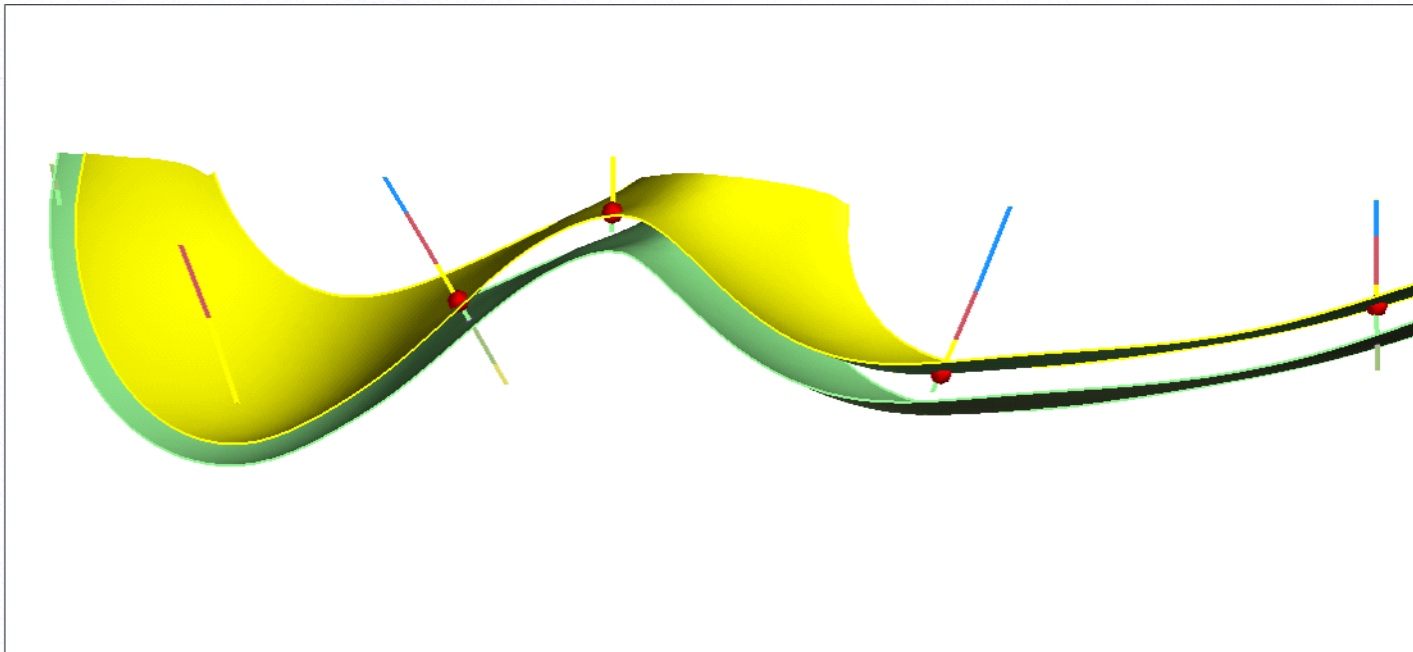

Can be used for a **Deposit** or **Erosion** contact type

VEIN SYSTEM SURFACE

Combines individual veins into a **single interconnected system** of veins

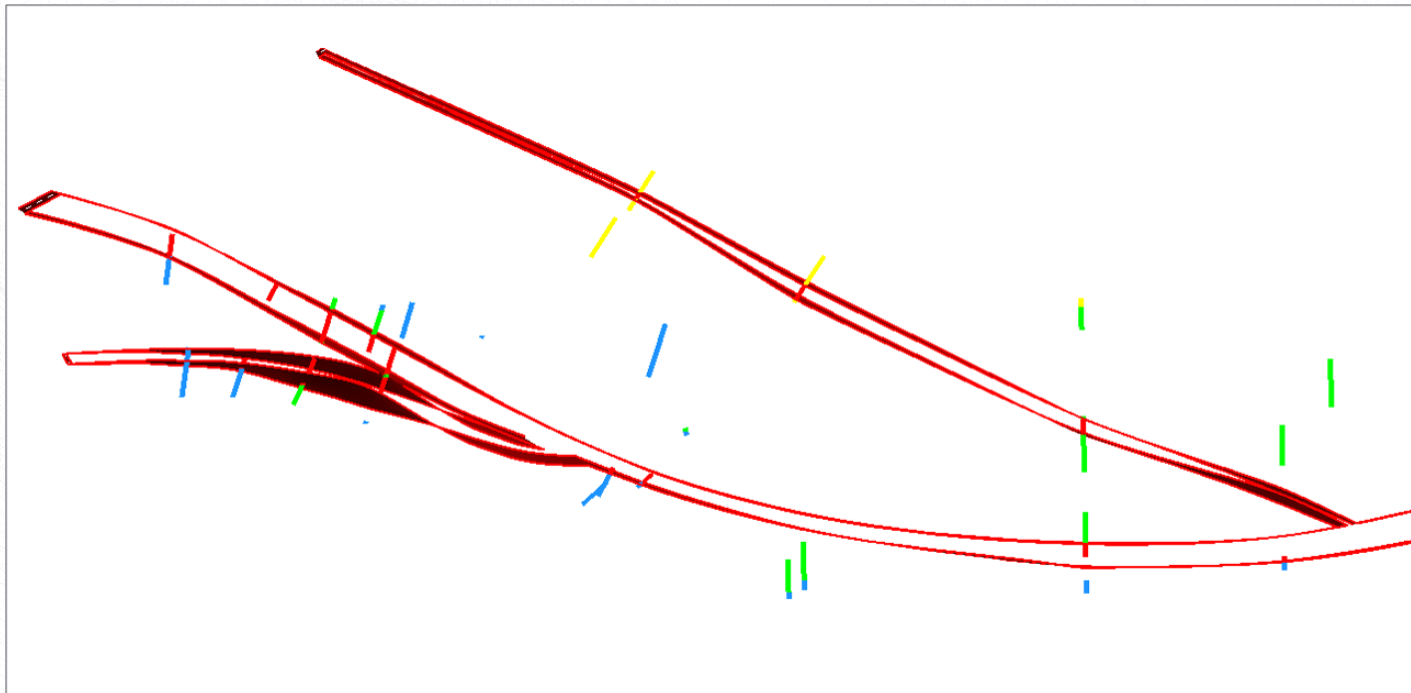

Can be used for a **Vein** contact type

STRATIGRAPHIC SEQUENCE

Generates **multiple** surfaces in a stratigraphic sequence in a **single pass**

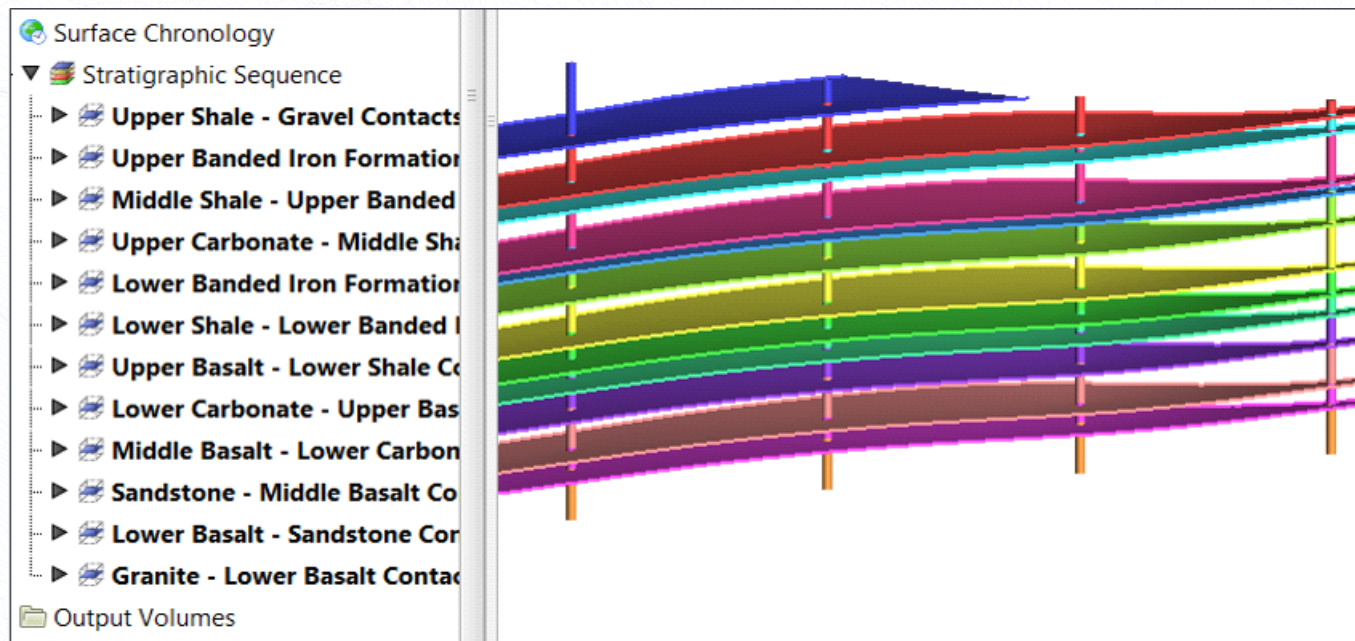

Can be used for a **Deposit** or **Erosion** contact type